

Joint Pin

- Radial Flat Faced
- Pancerny G-10 Pin
- 5/16-14 Piloted

Joint Collar

- Stainless Steel
- Genuine Ivory
- Ivory Substitute
- Phenolic
 - Black
 - Brown
 - White

Points

- 4
- 6
- 8 (4 Short, 4 Long)

Wrap

- Linen
 - Black w/ wht speck
 - Brown w/ wht speck
 - White w/ blk speck
 - Other _____
- Leather
 - Black smooth
 - Black textured
 - Embossed Elephant Ear
 - Embossed Stringray
 - Embossed Lizard - Teju
 - Embossed Crocodile
 - Brown Textured Pattern
 - Other _____
- Customer will send a wrap

Standard Shaft

- 1 13mm 12.75mm 12.5mm 12.25mm 12mm 11.75mm Tip _____
- 2 13mm 12.75mm 12.5mm 12.25mm 12mm 11.75mm Tip _____
- 3 13mm 12.75mm 12.5mm 12.25mm 12mm 11.75mm Tip _____

Low Deflection Shaft

- 1 13mm 12.75mm 12.5mm 12.25mm 12mm 11.75mm Tip _____
- 2 13mm 12.75mm 12.5mm 12.25mm 12mm 11.75mm Tip _____
- 3 13mm 12.75mm 12.5mm 12.25mm 12mm 11.75mm Tip _____

Name _____

Email _____

Phone _____

Order Date: _____

_____ Mos to completion

_____ Ounces

_____ Overall Length

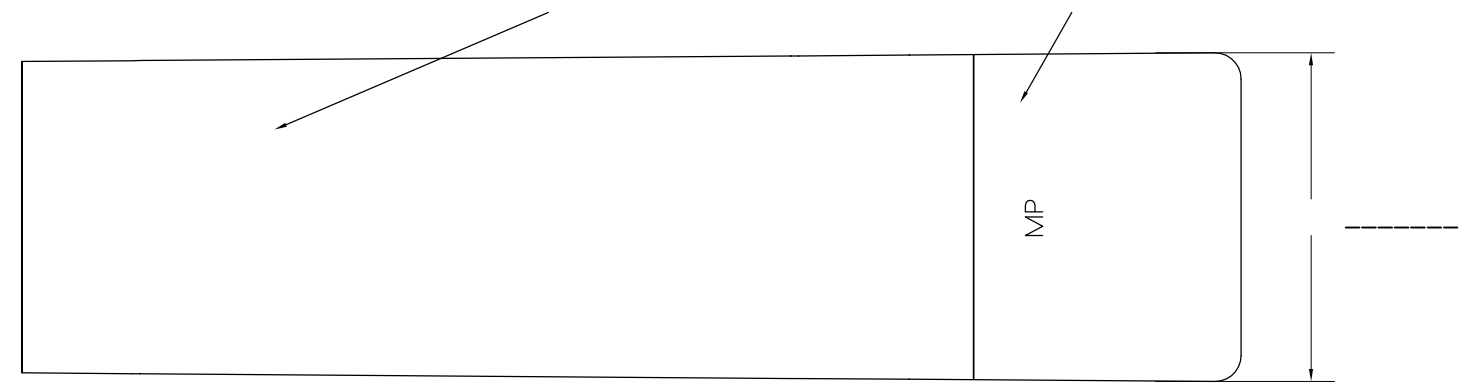

Special Instructions:

		8	16	32
		0		11.25
				22.5
		45		33.75
				56.25
				67.5
				78.75
		90		101.25
				112.5
				123.75
		135		146.25
				157.5
				168.75
		180		191.25
				202.5
				213.75
		225		236.25
				247.5
				258.75
		270		281.25
				292.5
				303.75
		315		326.25
				337.5
				348.75
		0		

www.customcuemaker.com
mike@customcuemaker.com

Cue name: _____

Form designed for print at 11 x 17

Sign: _____
Date: _____

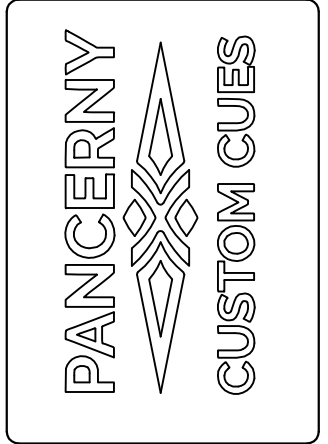

VERSION: 1.0
DRAWN BY:
DATE: